

PARTS CATALOG

BENELLI

5 SPEED

125 cc SPRITE

&

250 cc BARRACUDA

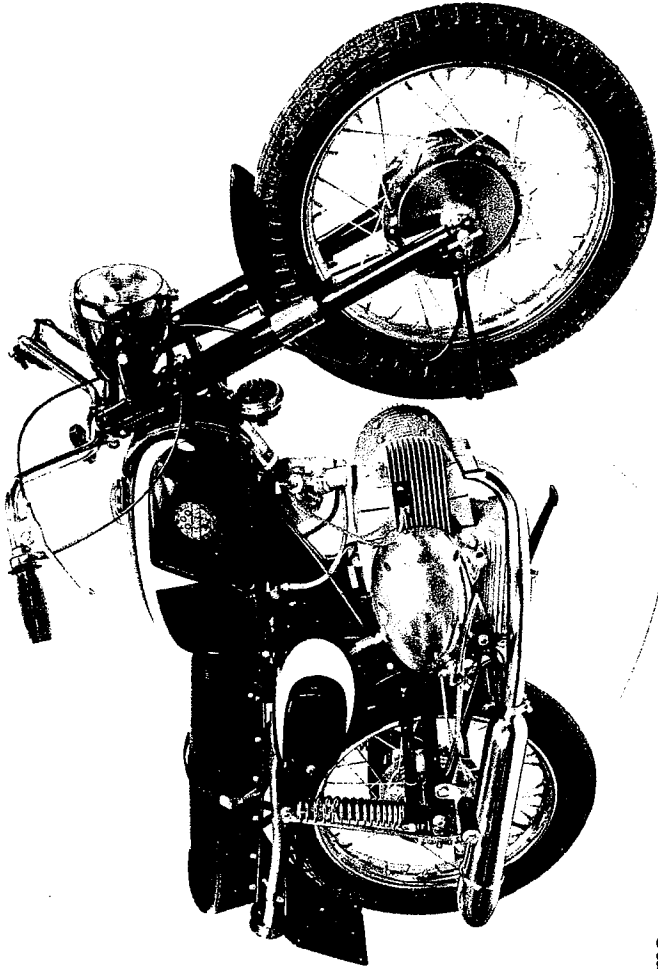

IMPORTANT

When ordering parts indicate clearly

- 1) Picture and Part Number
- 2) Description of Part
- 3) Description of Motorcycle and Frame

**USE ONLY
ORIGINAL
FACTORY
PARTS
\$1.00**

COSMOPOLITAN MOTORS, INCORPORATED

JACKSONVILLE & MEADOWBROOK ROADS, HATBORO, PA. 19040 (215) OS 2-9100

SOLE U.S. IMPORTERS AND DISTRIBUTORS OF BENELLI MOTORCYCLES / PIRELLI TIRES / AGV AND COSMO HELMETS

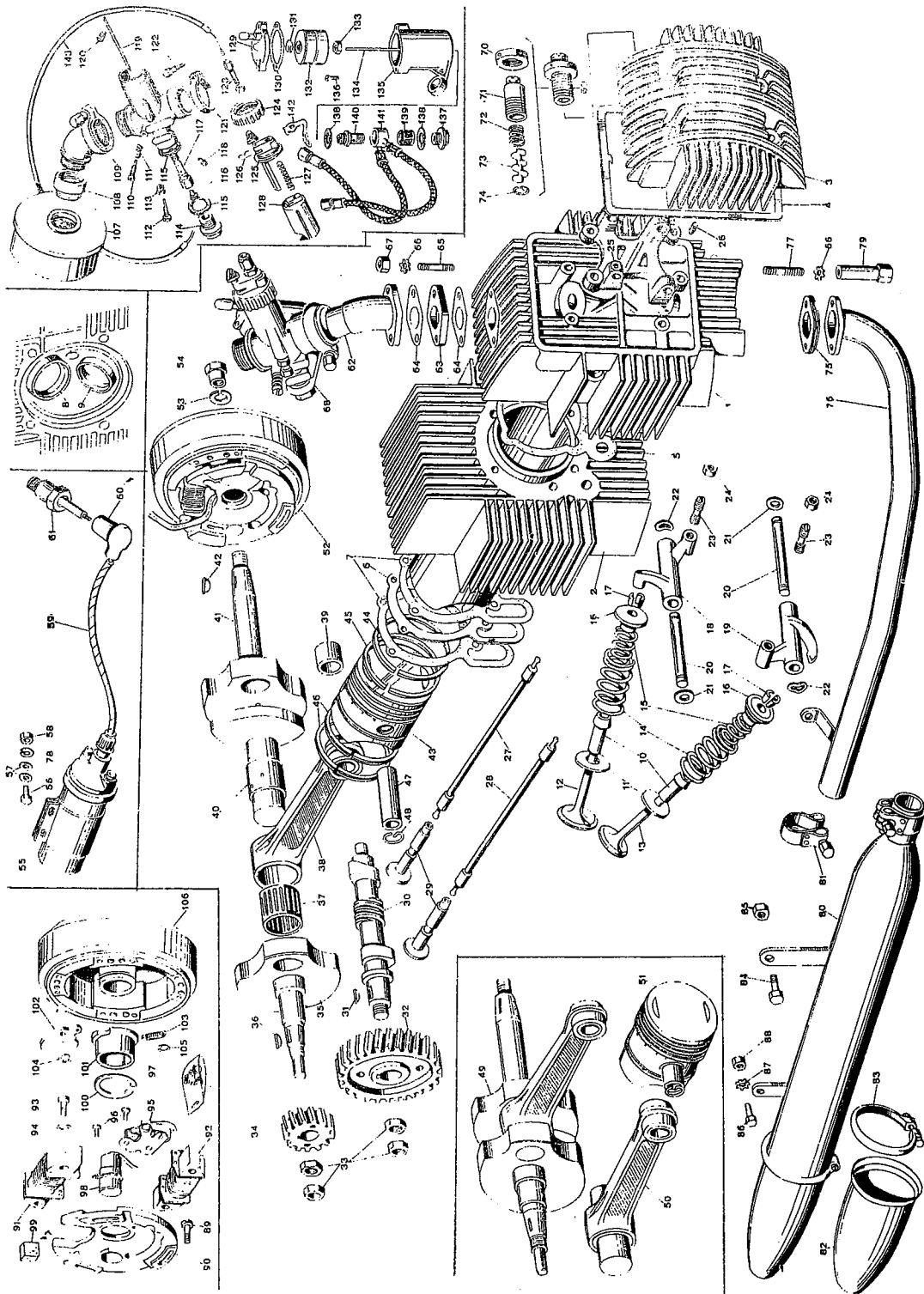

125cc and 250cc Barracuda

Engine Parts

Table #1

| Ref. No. | Part No. | Part No. | Description | Ref. No. | Part No. | Part No. | Description |
|----------|----------|----------|----------------------|----------|----------|----------|------------------------|
| 125cc | 250cc | 125cc | | No. | 125cc | 250cc | |
| 1 | 2838/1 | 3922 | Cylinder head | 31 | MU 164 | MU 164 | Woodruf key |
| 2 | 3791/1 | 3937 | Cylinder | 32 | 3656 | 3656 | Cam gear |
| 3 | 2420/2 | 2420/2 | Cover | 33 | 2313 | 2313 | Nut |
| 4 | 2421 | 2421 | Gasket | 34 | 2311/M | 2311/M | Pinion |
| 5 | 3934 | 3934 | Cylinder head gasket | 35 | 3994 | 3954 | R. H. half crank shaft |
| 6 | 2377 | 3935 | Base gasket | 36 | MU 8024 | MU 8024 | Woodruf key |
| 7 | 3875 | 3936 | Paper gasket | 37 | 3829/A | 3829/A | Roller cage complete |
| 8 | 3665 | 2826 | Intake valve seat | 38 | 3442 | 3909 | Connecting rod |
| 9 | 3822 | 2837 | Exhaust valve seat | 39 | 3238 | 3924 | Piston pin bushing |
| 10 | 3204 | 3823 | Valve guide | 40 | 3434 | 3724 | Crank pin |
| 11 | 3203 | 3203 | Lower plate | 41 | 3995 | 3955 | L. H. crank shaft |
| 12 | 2839/O | 3824 | Intake valve | 42 | MU 3817 | MU 3817 | Woodruf key |
| 13 | 2840/O | 3825 | Exhaust valve | 43* | 3696 | 3905 | Piston std. |
| 14 | 3208 | 3208 | Outer valve spring | 44* | 2894 | 3906 | Piston ring |
| 15 | 3269 | 3269 | Inner valve spring | 45* | 2894/1 | 3906/1 | Special piston ring |
| 16 | 3202 | 3202 | Upper plate | 46* | 2310/O | 3908 | Oil ring |
| 17 | 3201 | 3317 | Valve keeper | 47 | 2896 | 3925 | Piston ring |
| 18 | 3205 | 3205 | Int. rocker arm | 48 | 2892 | 2892 | Circlip |
| 19 | 3206 | 3206 | Exh. rocker arm | 49 | 3993 | 3953 | Crank shaft |
| 20 | 3199 | 3199 | Rocker arm shaft | 50 | SD 4 | SD 591 | Lower end |
| 21 | 3276 | 3276 | Trust washer | 51* | 3696/C | 3905/C | Piston complete |
| 22 | 3275 | 3275 | Spring washer | 52** | SD 595 | SD 596 | Flywheel magneto |
| 23 | 3366 | 3366 | Adjuster | 53 | MU 9321 | MU 9321 | Lock washer |
| 24 | 3367 | 3367 | Adjuster nut | 54 | 4066 | 4066 | Flywheel nut |
| 25 | 3198 | 3198 | Support | 55 | I 9161 | I 9161 | H. T. coil |
| 26 | 2656 | 2656 | Locking screw | 56 | 2522 | 2522 | Screw 5 x 14 |
| 27 | 2819 | 2819 | Intake push rod | 57 | MU 7559 | MU 7559 | Flat washer |
| 28 | 2818 | 2818 | Exhaust push rod | 58 | MU 3873 | MU 3873 | Nut |
| 29 | 2871 | 2871 | Cam follower | 59 | G 25 | G 25 | Spark plug wire |
| 30 | 4034 | 4034 | Cam shaft | 60 | G 7096 | G 7096 | Spark plug cup |

*43 and *51 are available in these oversizes:
 .008", .016", .024".

**Order part numbers SD 595 ADL75AN
 SD 596 ADP79AN

*44, *45 and *46 supplied in sets 2894/S (125cc)
 and 39068/S (250cc).

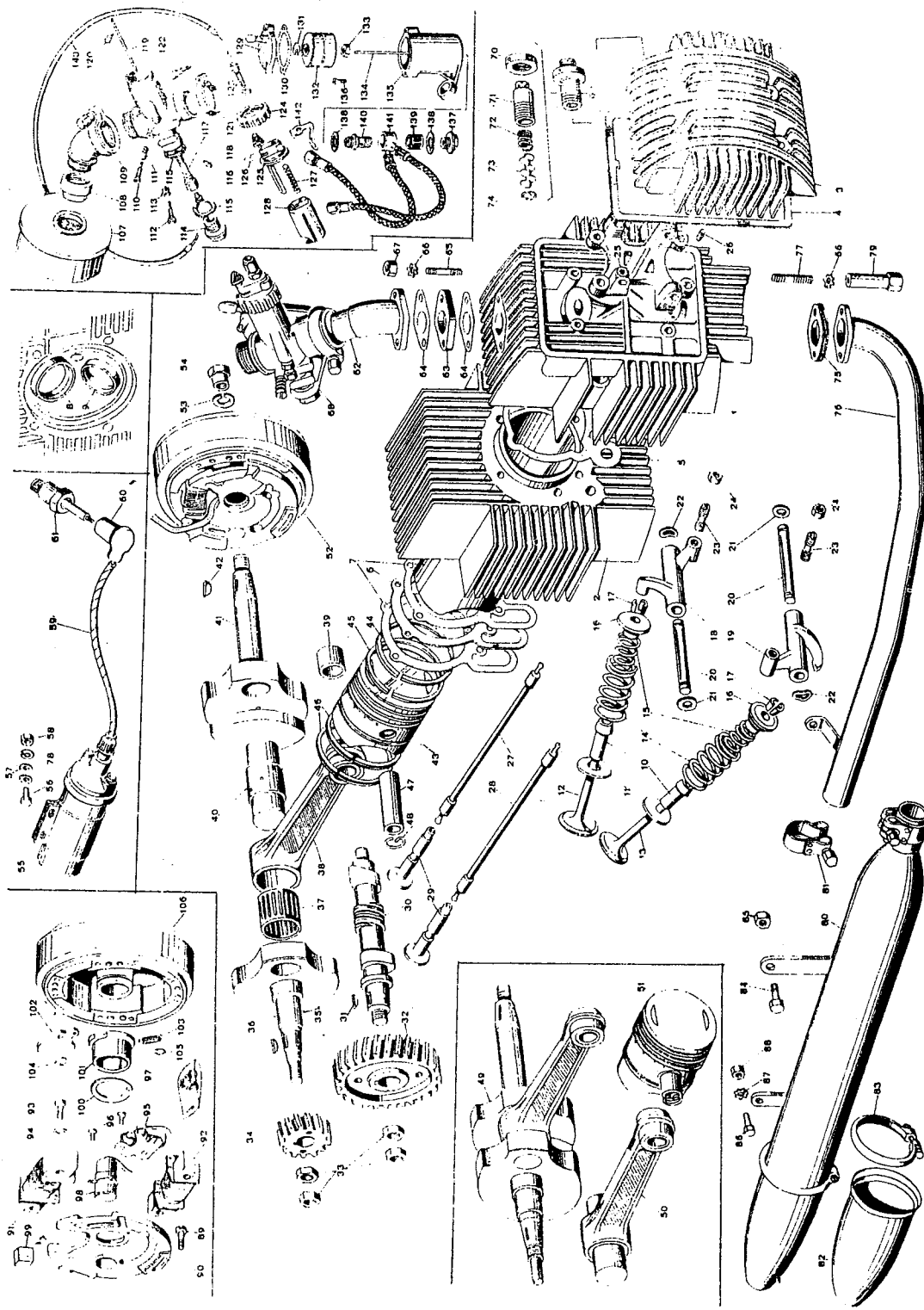

125cc and 250cc Barracuda

Engine Parts

Table #1

| Ref. No. | Part No. | Part No. | Description | Description | Ref. No. | Part No. | Part No. | Description |
|----------|----------|----------|--------------------|--------------------|----------|-------------|---------------|----------------------|
| No. | 125cc | 250cc | | | No. | 125cc | 250cc | |
| 61 | H 8508 | H 8508 | Spark plug | Spark plug | 93 | SD 551/G | SD 551/G | Screw |
| 62 | 2866 | 3921 | Intake manifold | Intake manifold | 94 | 1984/H | 1984/H | Washer |
| 63 | 2688 | 3927 | Insulating flange | Insulating flange | 95 | SD 5/B | SD 5/B | Point |
| 64 | 2543 | 2543 | Gasket | Gasket | 96 | G 221/3 | G 221/3 | Screw |
| 65 | 2695 | 2695 | Stud | Stud | 97 | G 221/5 | G 221/5 | Screw and washer set |
| 66 | MU 432 | MU 432 | Lock washer | Lock washer | 98 | 1984/F | 1984/F | Condenser |
| 67 | 2511 | 2511 | Nut | Nut | 99 | SD 551/E | SD 551/E | Grease felt |
| 68* | DE 4115 | DE 4119 | Carburetor | Carburetor | 100 | SD 5/D | SD 5/D | Clip |
| 69 | SD 3 | SD 3 | Breather complete | Breather complete | 101 | SD 5/C | SD 5/CA | Cam |
| 70 | 2698 | 2698 | Ring | Ring | 102 | I 9158/G | I 9158/G | Platè |
| 71 | 2697 | 2697 | Breather body | Breather body | 103 | SD 5/E | SD 5/E | Spring |
| 72 | 2700 | 2700 | Spring | Spring | 104 | I 9158/I | I 9158/I | Clip |
| 73 | 2699 | 2699 | Breather plate | Breather plate | 105 | I 9158/L | I 9158/L | Clip |
| 74 | 2696 | 2696 | Clip | Clip | 106 | SD 595/A | SD 592/A | Flywheel |
| 75 | 2473 | 2473 | Exh. pipe gasket | Exh. pipe gasket | 107 | 10065/F35/1 | DE10029/F20/1 | Air filter |
| 76 | 4102 | 4102 | Exhaust pipe | Exhaust pipe | 108 | DE 1716 | DE 1716 | Spacer |
| 77 | 2542 | 2542 | Stud | Stud | 109 | 1701/C | DE 1701/C | Elbow with clamp |
| 78 | L 11 | L 11 | Lock washer | Lock washer | 110 | DE 2115 | DE 2115 | Mixture adj. screw |
| 79 | 2550 | 2550 | Special nut | Special nut | 111 | DE 1411 | DE 1411 | Spring |
| 80 | 4095 | 4095 | Muffler | Muffler | 112 | DE 1095 | DE 1095 | Slide Stop screw |
| 81 | SD 167 | SD 167 | Clamp | Clamp | 113 | DE 1096 | DE 1096 | Nut |
| 82 | SD 306/A | SD 306/A | Muffler tail | Muffler tail | 114 | DE 2086 | DE 2086 | Plug |
| 83 | H 8504/B | H 8504/B | Tail clamp | Tail clamp | 115 | DE 1382 | DE 1382 | Gasket |
| 84 | M 129 | M 129 | Allen screw (10x6) | Allen screw (10x6) | 116 | 1486/95 | DE 1486/100 | Main jet |
| 85 | MU 7929 | MU 7929 | Nut | Nut | 117 | 2058 | DE 3171 | Needle jet |
| 86 | MU 614 | MU 614 | Bolt | Bolt | 118 | 1488/40 | DE 1488/45 | Minimum jet |
| 87 | MU 589 | MU 589 | Lock Washer | Lock Washer | 119 | 2343/10 | DE 2343/11 | Needle |
| 88 | MU 187 | MU 187 | Nut | Nut | 120 | DE 1407 | DE 1407 | Clip |
| 89 | 3594 | 3594 | Allen screw | Allen screw | 121 | 1722 | DE 1723 | Clamp |
| 90 | SD 551/B | SD 551/B | Baking plate | Baking plate | 122 | DE 1111 | DE 1111 | Screw |
| 91 | SD 593/A | SD 593/A | Light coil | Light coil | 123 | DE 1104 | DE 1104 | Cable Adjuster |
| 92 | SD 551/C | SD 551/C | Ignition coil | Ignition coil | 124 | DE 2324 | DE 2324 | Ring |

*Order Pa. Nos. DE 4115 UB22BS -DE 4119 UB24BS2

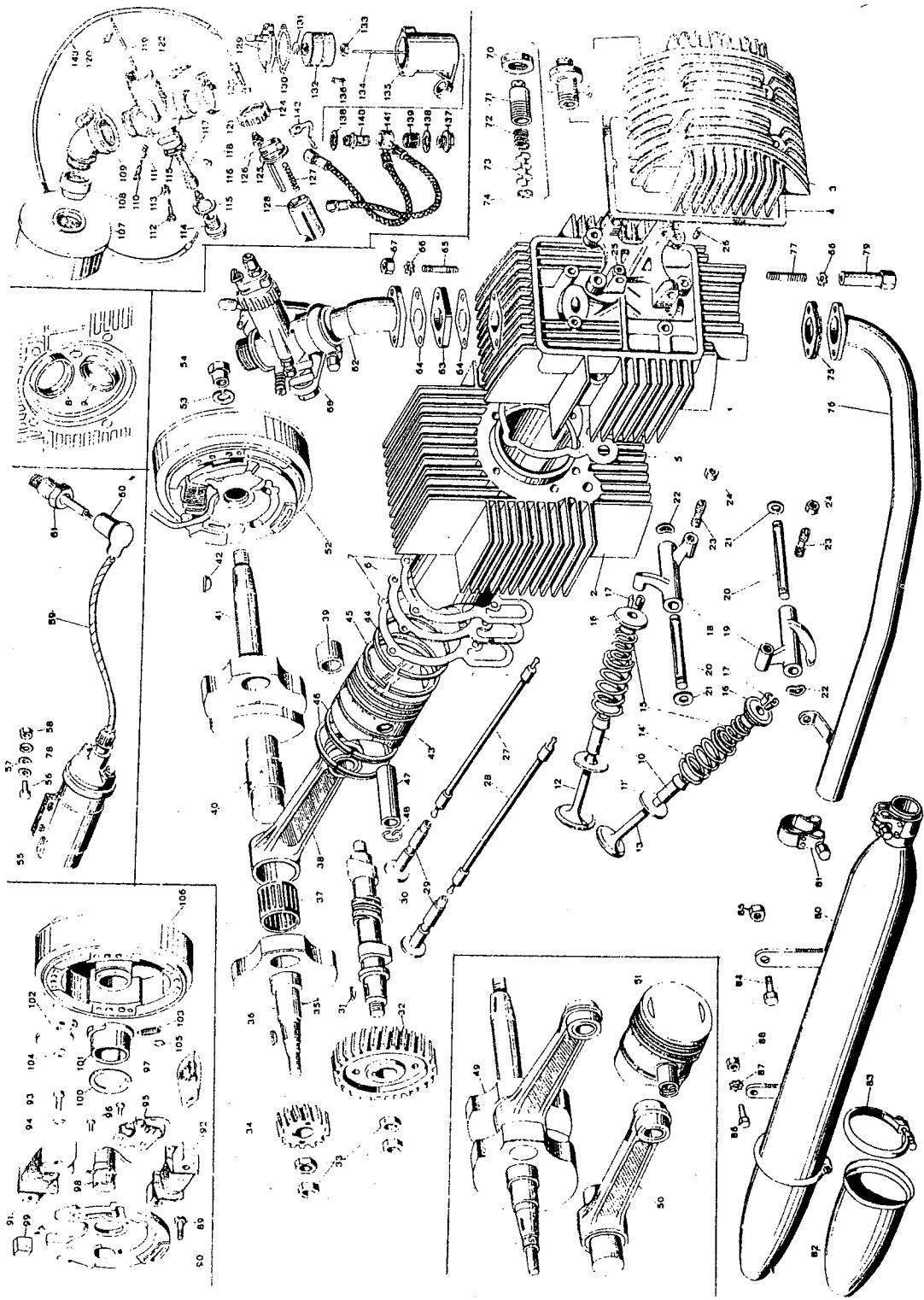

125cc and 250cc Barracuda

Engine Parts

Table #1

| Ref. No. | Part No. | Part No. | Description | Ref. No. | Part No. | Part No. | Description |
|----------|----------|------------|------------------|----------|----------|----------|-------------|
| No. | 125cc | 250cc | | No. | 125cc | 250cc | |
| 125 | DE 3584 | DE 3584 | Chamber cover | | | | |
| 126 | DE 3570 | DE 3570 | Clip | | | | |
| 127 | DE 2372 | DE 2372 | Spring | | | | |
| 128 | 4361/60 | DE 4361/80 | Slide | | | | |
| 129 | DE 4100 | DE 4100 | Float bowl cover | | | | |
| 130 | DE 1414 | DE 1414 | Gasket | | | | |
| 131 | DE 1452 | DE 1452 | Clip | | | | |
| 132 | DE 2189 | DE 2189 | Float bowl | | | | |
| 133 | DE 3170 | DE 3170 | Nut | | | | |
| 134 | DE 2117 | DE 2117 | Needle | | | | |
| 135 | DE 4891 | DE 4891 | Float bowl body | | | | |
| 136 | DE 1580 | DE 1580 | Screw | | | | |
| 137 | DE 1494 | DE 1494 | Plug | | | | |
| 138 | DE 1416 | DE 1416 | Gasket | | | | |
| 139 | DE 1419 | DE 1419 | Filt er | | | | |
| 140 | DE 3169 | DE 3169 | Needle seat | | | | |
| 141 | 3522 | 3522 | 2 way fuel line | | | | |
| 142 | DE 5670 | DE 5670 | Lock plate | | | | |
| 143 | 3714/2 | 3714/2 | Throttle cable | | | | |

